



NDS3542D

Multi-input Modulator



Outline

NDS3542D multi-input modulator is DEXIN's all-in-one device which integrates demodulation, trans-mux and modulation in one case to convert signals into RF output. It is a 1-U case which supports 4 tuner inputs to receive signal from satellite, cable or terrestrial. To meet customers' various requirements, NDS3542D is also equipped with 2 ASI input, and output with 2 groups separate ASI ports and 2 MPTS UDP IP port. The output modulated signals are to be received by TVs, STB and etc.

The USB port is designed to record encoded video (TS) and save it in ts files in the USB Keys or Hard Disks, and then the ts files can be playback through the USB port.

The four CAMs/CIs (Optional) accompanied and BISS modules can descramble the programs input from 4 Tuner inputs. Its pluggable structure design greatly facilitates the change of modules (demodulator) as needed.



All the specifications are subject to change without any further notice. All rights reserved.

Address: No. 10 & No. 12, Wuxing Fourth Road, Wuhou District, Chengdu 610045, Sichuan, P.R. China
www.dsdvb.com/English Tel: +86-028-85558928 Fax: +86-028-85585255 Email: sunyu@dsdvb.com



USB Recorder & Player

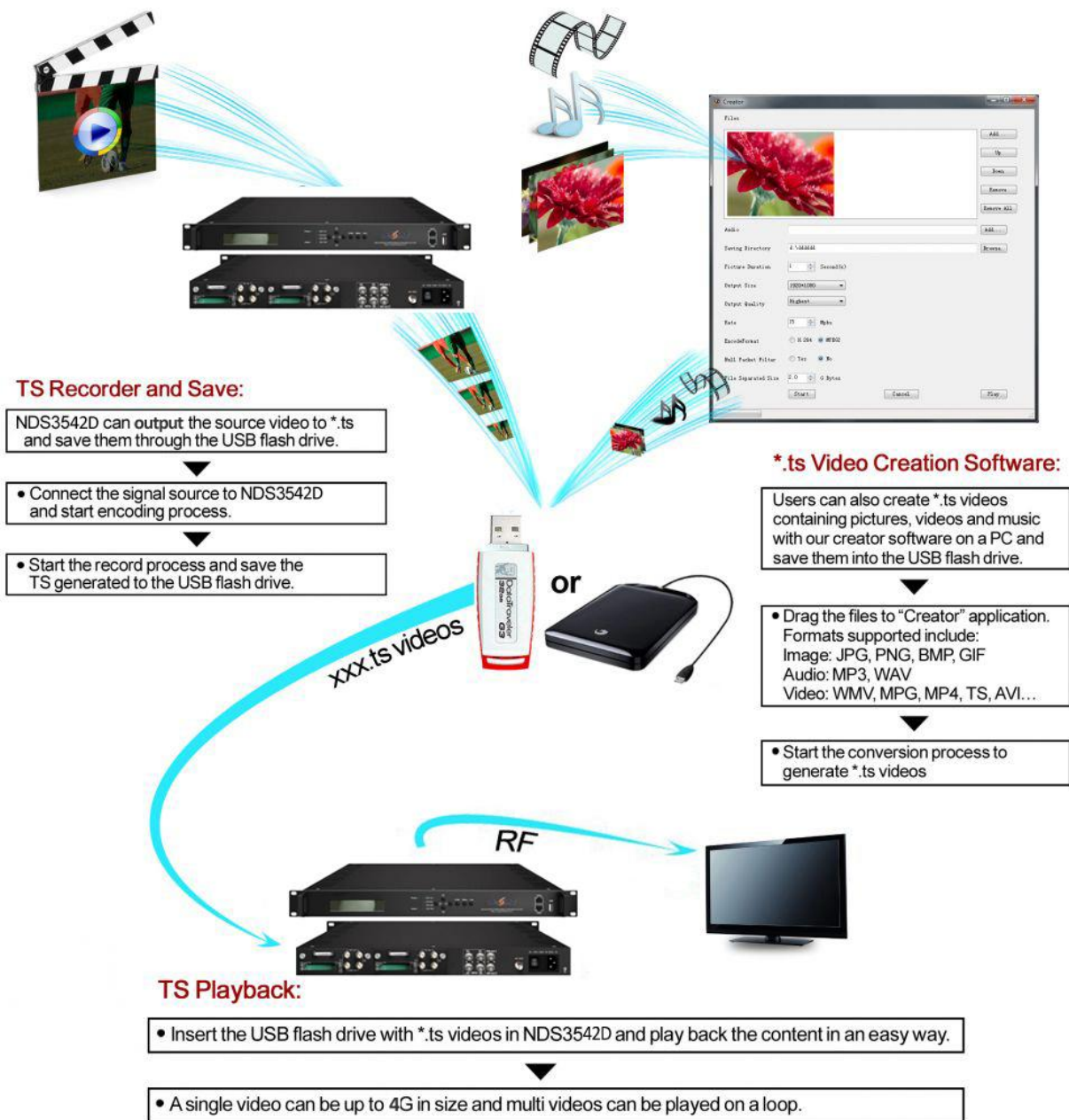

USB Flash Drive Specifications Required: High Speed 2.0; File System FAT32

Key Features

- Support 4 DVB-C/(T)/S/S2/ISDB-T Tuner and 2 ASI input ports
- Support accurate PCR adjusting
- Support PSI/SI editing and inserting
- PID Remapping
- Excellent RF output performance index, MER≥40db



All the specifications are subject to change without any further notice. All rights reserved.

Address: No. 10 & No. 12, Wuxing Fourth Road, Wuhou District, Chengdu 610045, Sichuan, P.R. China

Website: www.dsdvb.com/English | Tel: +86-028-85558928 | Fax: +86-028-85585255 | Email: sunyu@dsdvb.com

- 2*DVB-T RF out or 4*DVB-C RF out optional;
- 2 separate ASI&IP (2*MPTS over UDP) mirror 2 RF output
- 4 CAM decrypt multiple programs from 4 Tuner input(Optional)
- Support BISS descrambling
- Record encoded TS and playback TS files (*.ts) through USB port
- Support LCD display and keyboard
- Support Web management, Updates via web and USB

Specifications

Input	4 DVB-C/(T)/S/S2/ISDB-T Tuner (Optional) and 2 ASI input		
Tuner Section	DVB-C	Standard	J.83A(DVB-C), J.83B, J.83C
		Input Frequency	30MHz-1000Mhz
		Constellation	16/32/64/128/256 QAM
	DVB-(T)	Input Frequency	30MHz-999.999Mhz
		Bandwidth	6/7/8M bandwidth
	DVB-S	Input Frequency	950-2150MHz
		Symbol rate	2-45Msps
		Signal Strength	-65~-25dBm
		FEC Demodulation	1/2, 2/3, 3/4, 5/6, 7/8 QPSK
	DVB-S2	Input Frequency	950-2150MHz
		Symbol rate	QPSK 1~45Mbauds 8PSK 2~30Mbauds
		Code rate	1/2, 3/5, 2/3, 3/4, 4/5, 5/6, 8/9, 9/10
		Demodulation Mode	QPSK, 8PSK
	ISDB-T	Input Frequency Range	170~230Mhz and 470~860MHz
		Bandwidth	6MHz(6,7,8MHz optional)
Input Level		0~-80dBm	
Multiplexing	Maximum PID Remapping	128per input channel	
	Function	PID remapping (automatically or manually)	
		Accurate PCR adjusting	
Modulation	DVB-C	Standard	J.83A(DVB-C), J.83B, J.83C
		MER	≥40dB
		RF frequency	30~999MHz, 1KHz step
		RF output level	-20~0dbm(87~107 dbμV),0.1db step
		Symbol rate	5.0Msps-9.0Msps, 1ksps stepping
		RF Out	4*DVB-C carriers output
		Generate PSI/SI table automatically	

			J.83A	J.83B	J.83C
		Constellation	16/32/64/128 /256QAM	64/256 QAM	64/256 QAM
		Bandwidth	8M	6M	6M
	DVB-T	Bandwidth	6M, 7M, 8M		
		Constellation	QPSK, 16QAM, 64QAM		
		Code rate	1/2, 2/3, 3/4, 5/6, 7/8		
		Guard Interval	1/32, 1/16, 1/8, 1/4		
		Transmission Mode:	2K, 8K		
		MER	≥40dB		
		RF frequency	30~999MHz, 1KHz step		
		RF Out	2*DVB-T carriers output		
		RF output level	-20~0dbm(87~107 dbμV),0.1db step		
System	Local interface	LCD + control buttons			
	Remote management	Web NMS			
	Stream Out	2 ASI out(BNC type)			
		IP (2*MPTS over UDP) out (RJ45, 1000M)			
	Language	English and Chinese			
Upgrading	Web and USB				
General	Dimension	482mm×300mm×44.5mm(W*D*H)			
	Weight	3.7kg			
	Temperature	0~45℃ (Operation) ; -20~80℃ (Storage)			
	Power	AC 100V±10%/50/60HZ; AC 220V±10%, 50/60HZ			
	Consumption	25W			

Working Principle

